

JUNE 2018

HOUSE & HOME

THE MAGAZINE OF HOME & STYLE

The Best Steak You'll
Ever Taste... Promise!

FRESH SPRING STYLE

NEW DECORATING
IDEAS AND BEST
GARDEN SECRETS
FROM THE PROS

MONEY MATTERS:

TECH ON A BUDGET,
BARGAIN FINDS
AND THE REAL
COST OF "WOW"

+ BATHROOMS!

- 3 DREAM RETREATS
- 10 HOT TRENDS
- 15 SOAKER TUBS

June 2018

JUST ADD WATER

THREE BATHROOMS THAT TAKE RELAXING IN THE TUB OR LINGERING IN THE SHOWER TO A WHOLE NEW LEVEL.

Text by **EMILY EVANS** | Room photography by **DONNA GRIFFITH**

NO 1 | Old World Elegance



LEFT: Interior design by Lisa Worth, Worth Interior Design; contracting, Tridium Contracting; sconces by Visual Comfort, Cocoon Furnishings; vanity, mirror, privacy panel construction, Rickwood. **BELOW:** Shower fixtures, toiletries and towels (throughout), Ginger's; basket, Pimlico Design Gallery; tile, Antica Tile & Stone.



THE ASK: Not everyone is bold enough to go for dramatic, heavily veined tile — especially on their floors and walls — but author and antique collector Arnold Logan was ready to bring his 210-square-foot space over to the dark side. “Arnold has a fine appreciation for antiquity and he requested that the space look like it had evolved over time,” says interior designer Lisa Worth. The traditional envelope, including an existing wood-burning fireplace, stately mouldings and expansive windows overlooking 14 hectares of rolling hills in Aurora, Ont., were the building blocks for Lisa’s vision.

THE RESULT: “The projects that have the most visual impact are the ones where clients have pushed me out of my comfort zone,” says Lisa. Relocating the tub to face the sculptural limestone fireplace and swapping the location of the vanity and shower were both costly moves, but the improved flow was worth it. A custom walnut vanity, mirror and slatted wall next to the toilet complement the nailhead-detailed copper tub and hammered-copper sink. “We couldn’t do all copper fixtures,” says Lisa, “and I worried that brass would fight with the copper, so I looked to elegant polished nickel for the hardware and fixtures.” A Lucite chandelier was the finishing flourish to accentuate the 11-foot-high ceilings without stealing the spotlight from the tub.



Shower controls tucked into this niche allow you to turn on the shower without getting wet

Design Details

SQ.FT.
210

**COUNTERTOP &
STATEMENT TILE**
Nero Marquina
marble

FIXTURES
Polished nickel

TUB
Copper

VANITY
Walnut

THE FLOOR PLAN

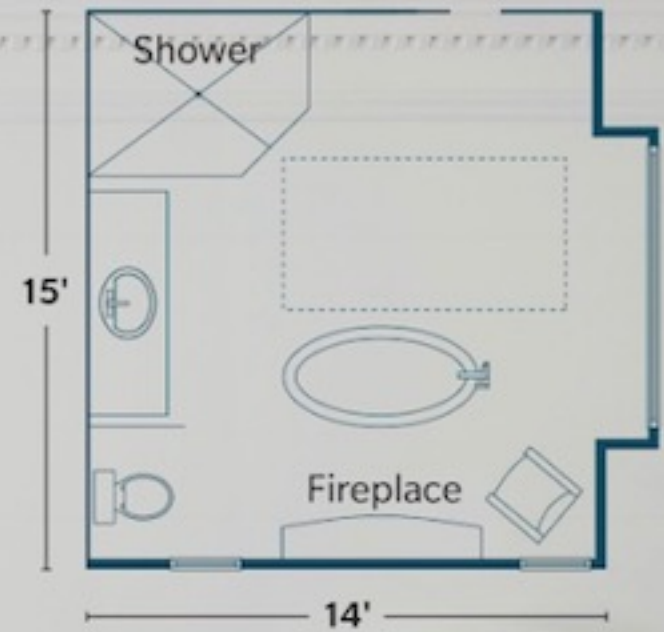

Tub, Taps Bath Centre;
tub filler, Ginger's;
chandelier, Cocoon
Furnishings; **wall colour,**
White Dove (OC-17),
Benjamin Moore; **bowl,**
Pimlico Design Gallery.

“What I love most about this room is that it’s a living space – bathrooms can feel cold and austere, but this one has an intrinsic warmth”

– Lisa Worth

Produced by Stacey Smithers/Photography by Denise Jones
Productions (portrait)/All floor plan illustrations by Josh Wiggan

